

A1

DO NOT SCALE

File: CNW P3B-ATK-P3B-Z0-DR-C-950750.dwg
Date: Apr 19, 2022 - 12:14pm
Plotted by: Dhanon

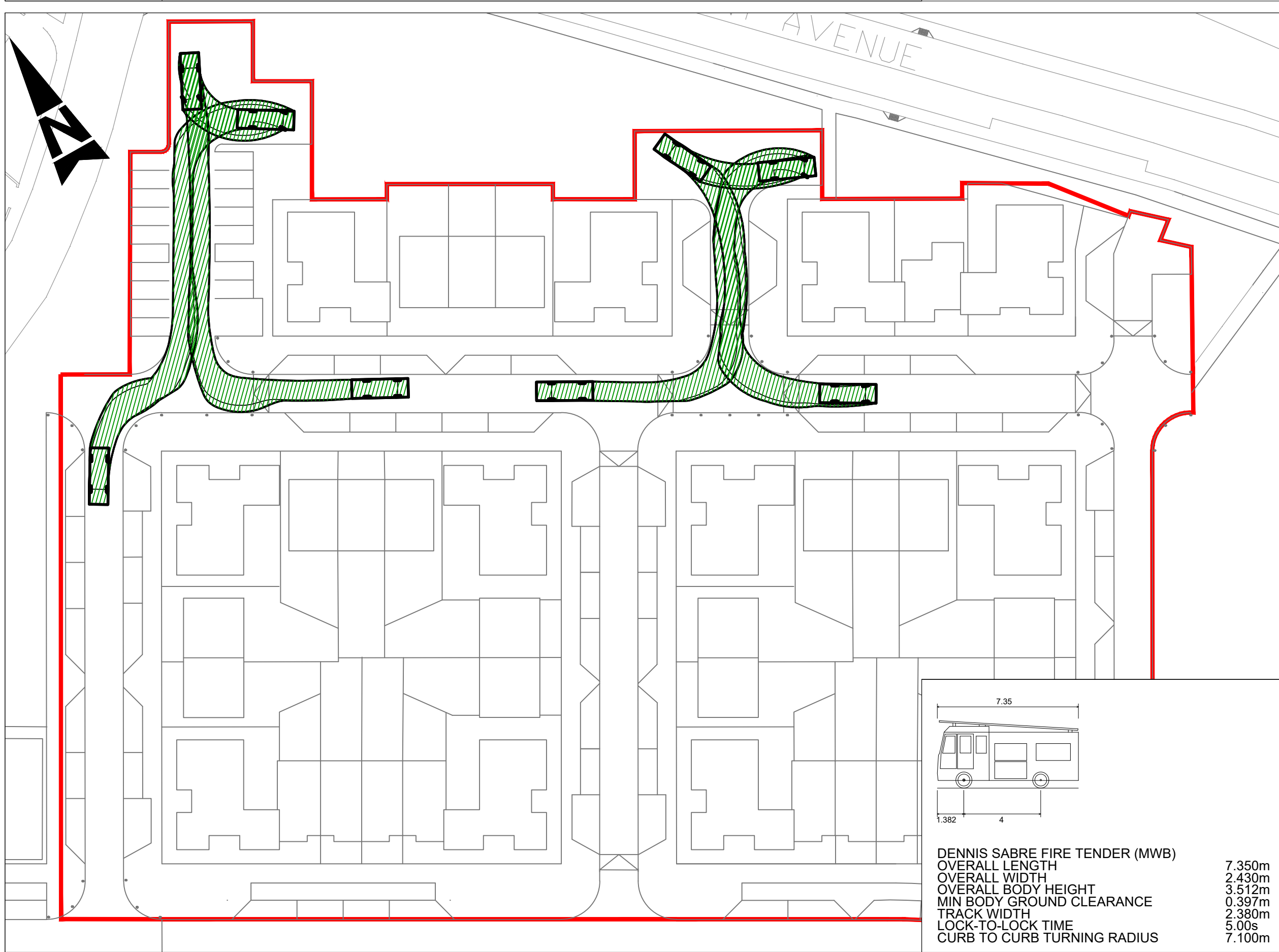
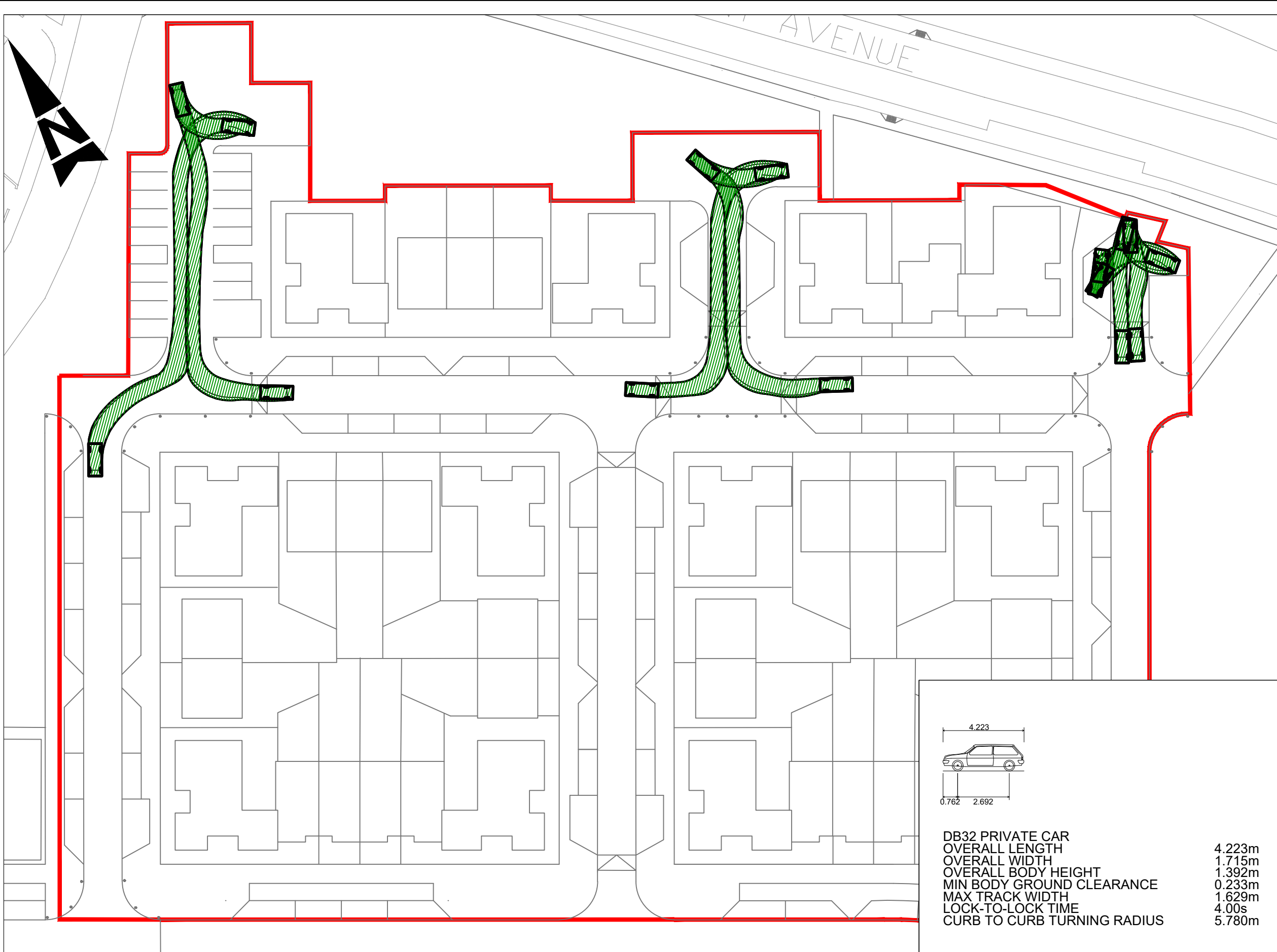
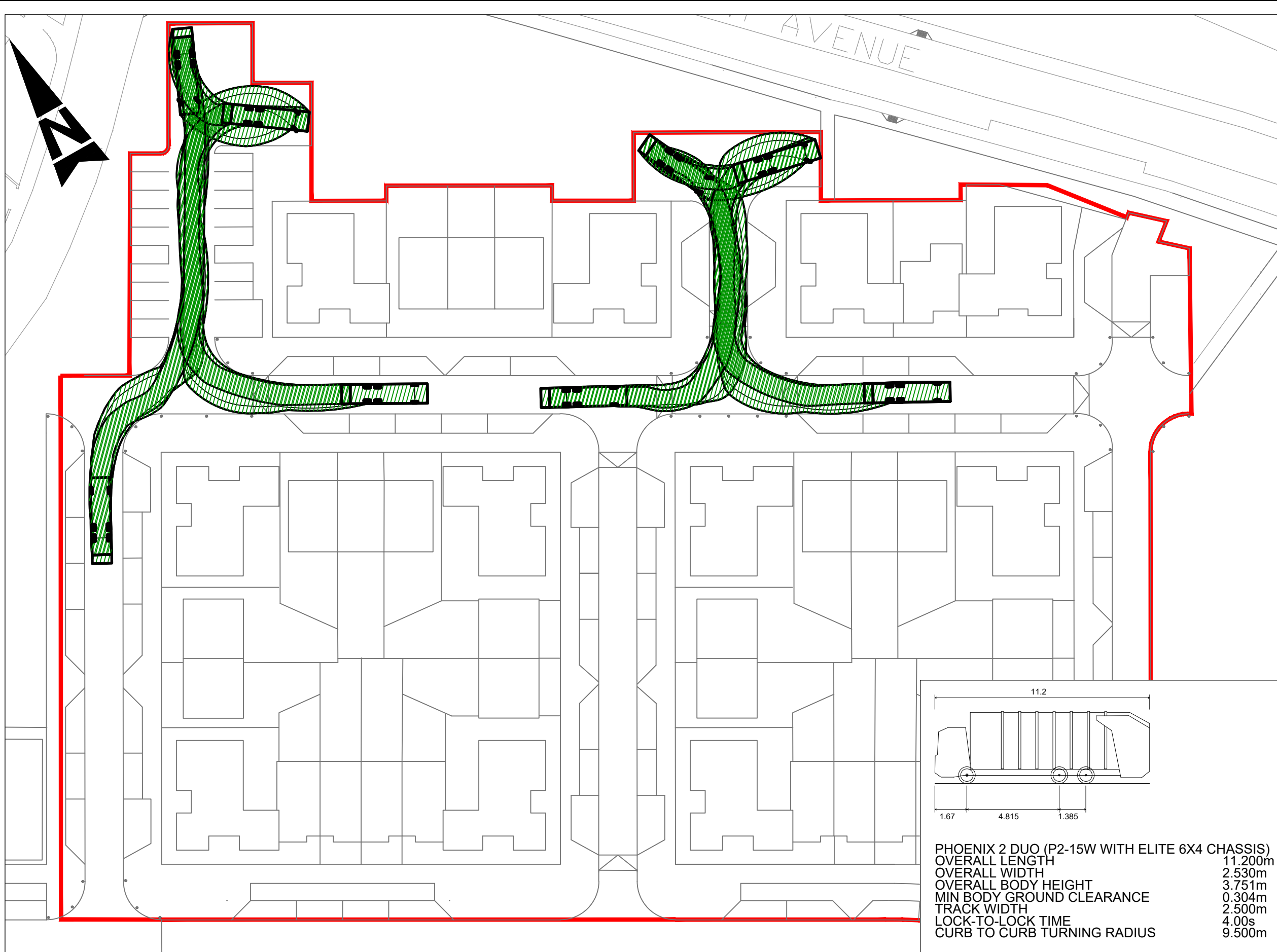

- GENERAL NOTES**
1. ALL DIMENSIONS ARE IN MILLIMETRES UNLESS NOTED OTHERWISE
 2. ONLY WRITTEN DIMENSIONS SHALL BE USED. NO DIMENSIONS SHALL BE SCALED FROM THE DRAWINGS
 3. ALL LEVELS ARE IN METRES AND ARE TO MALIN HEAD DATUM
 4. ALL COORDINATES ARE IN METRES AND ARE TO IRISH TRANSVERSE MERCATOR
 5. DRAWINGS ARE TO BE READ IN CONJUNCTION WITH THE SPECIFICATION.

LEGEND:

— PHASE 3B BOUNDARY

© ORDNANCE SURVEY IRELAND LICENSE No. AR 0082521.
ORDNANCE SURVEY IRELAND & GOVERNMENT OF IRELAND

OS REFERENCE:
6382-02 6382-03

Rev	Description	By	Date	Chk'd	Auth
P04	ISSUED FOR PART 8 PLANNING	GM	14.04.22	MB	MOS
P03	ISSUED FOR PRE-PART 8	GM	23.02.22	MK	MOS
P02	REVISED FOR STAGE 2A	GM	13.08.21	MK	MOS
P01	ISSUED FOR STAGE 2A	GM	16.07.21	MK	MOS

ATKINS
Member of the SNC-Lavalin Group

Atkins House, 150 Airside Business Park, Swords, Co. Dublin
Tel (+353) 01 810 8000
Fax (+353) 01 810 8001

Unit 2B, 2200 Cork Airport Business Park, Cork
Tel (+353) 021 429 0300
Fax (+353) 021 429 0360

2nd Floor Technology House Parkmore Technology Park, Galway
Tel (+353) 091 786 0550
Fax (+353) 091 779 830

Client	Cork City Council
Project	CorkNW Regeneration Quarter Phase 3B

Purpose		PART 8 PLANNING			
Title					
VEHICLE TRACKING SHEET					
Original Scale		Design/Drawn	Checked	Authorised	
1:500@A1		GM	MK	MOS	
1:1000@A3		Date 10.05.21	Date 10.05.21	Date 10.05.21	
Status	Drawing Number				Rev
P	CNW P3B-ATK-P3B-Z0-DR-C-950750				P04

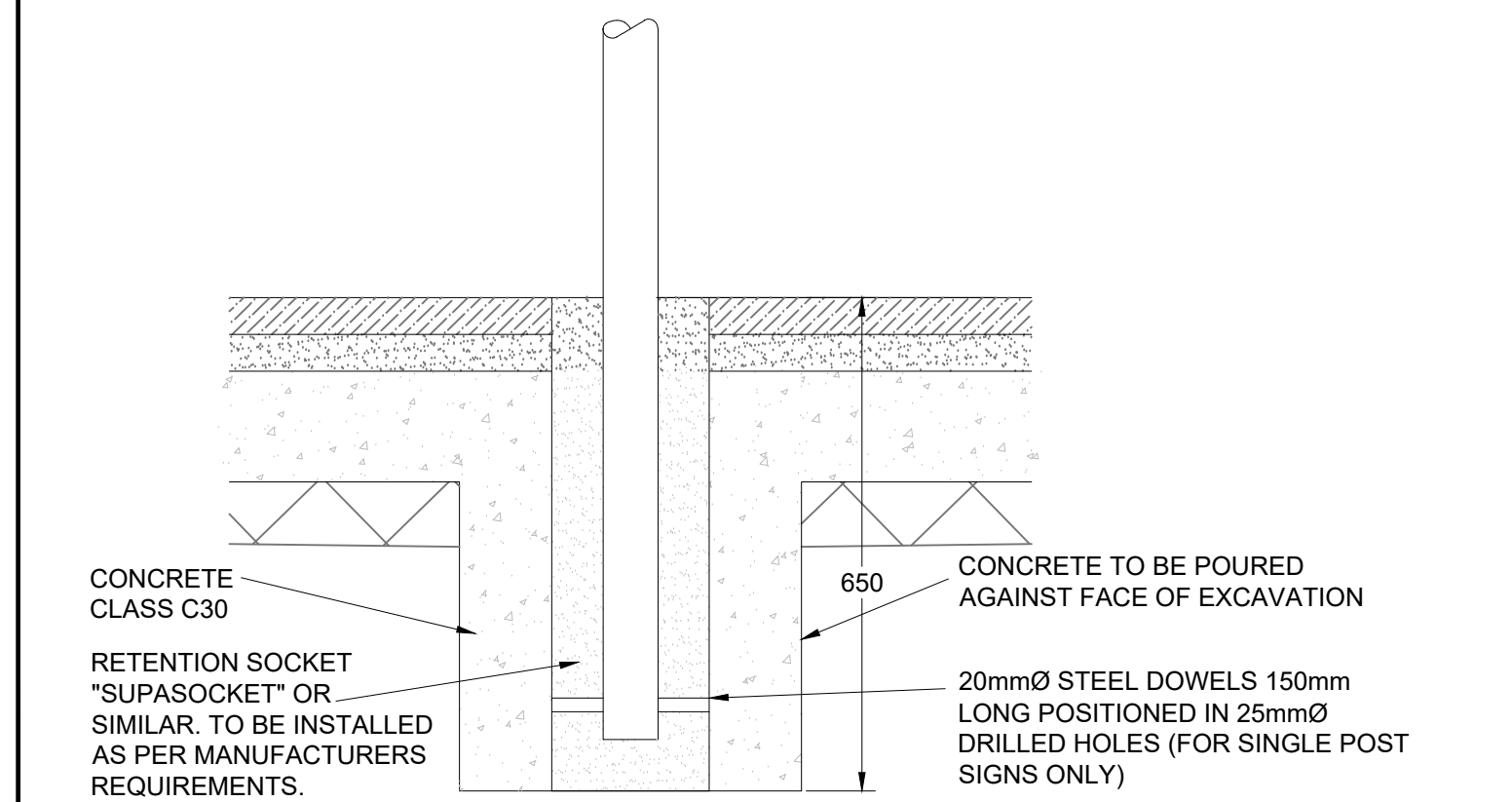
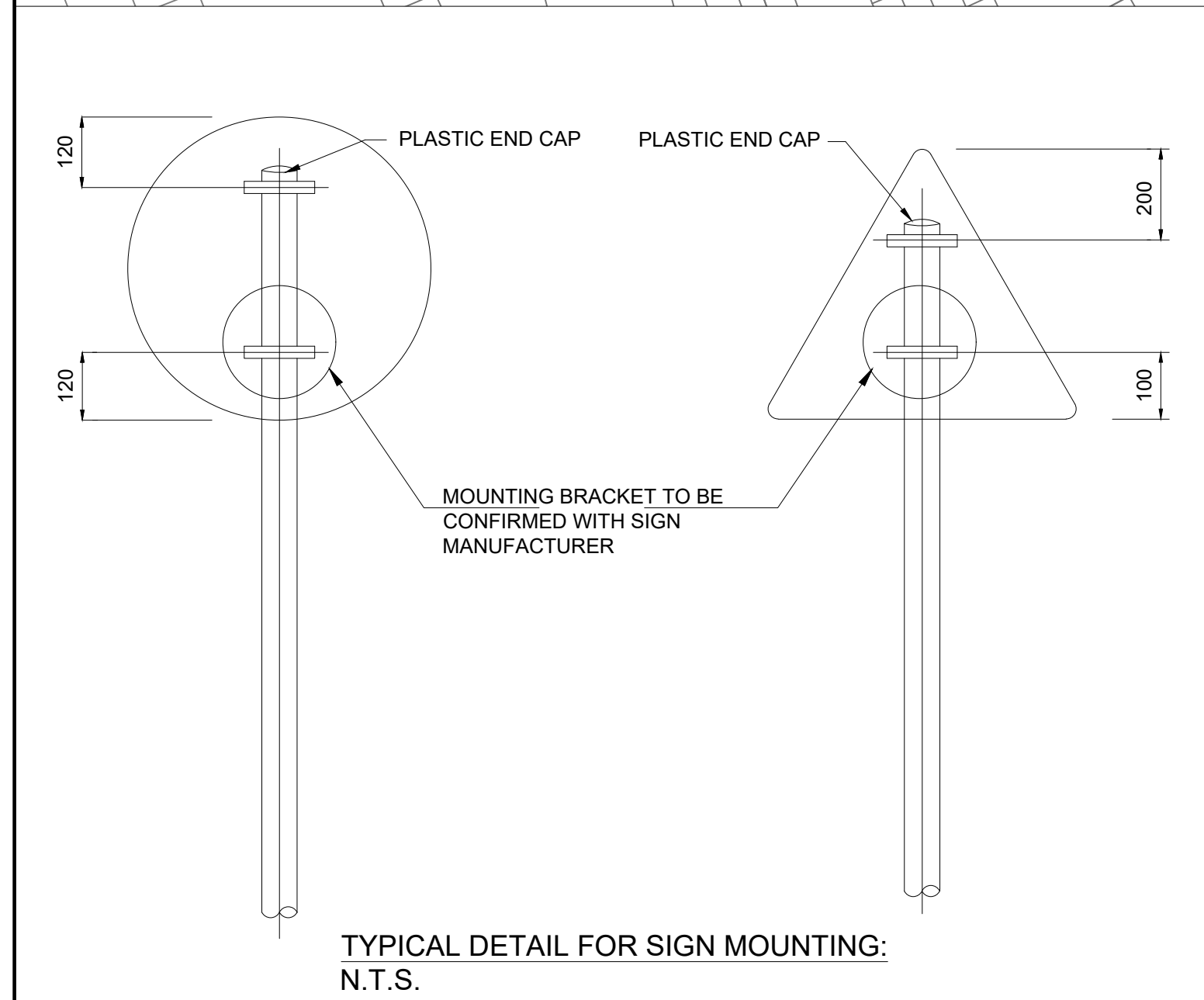

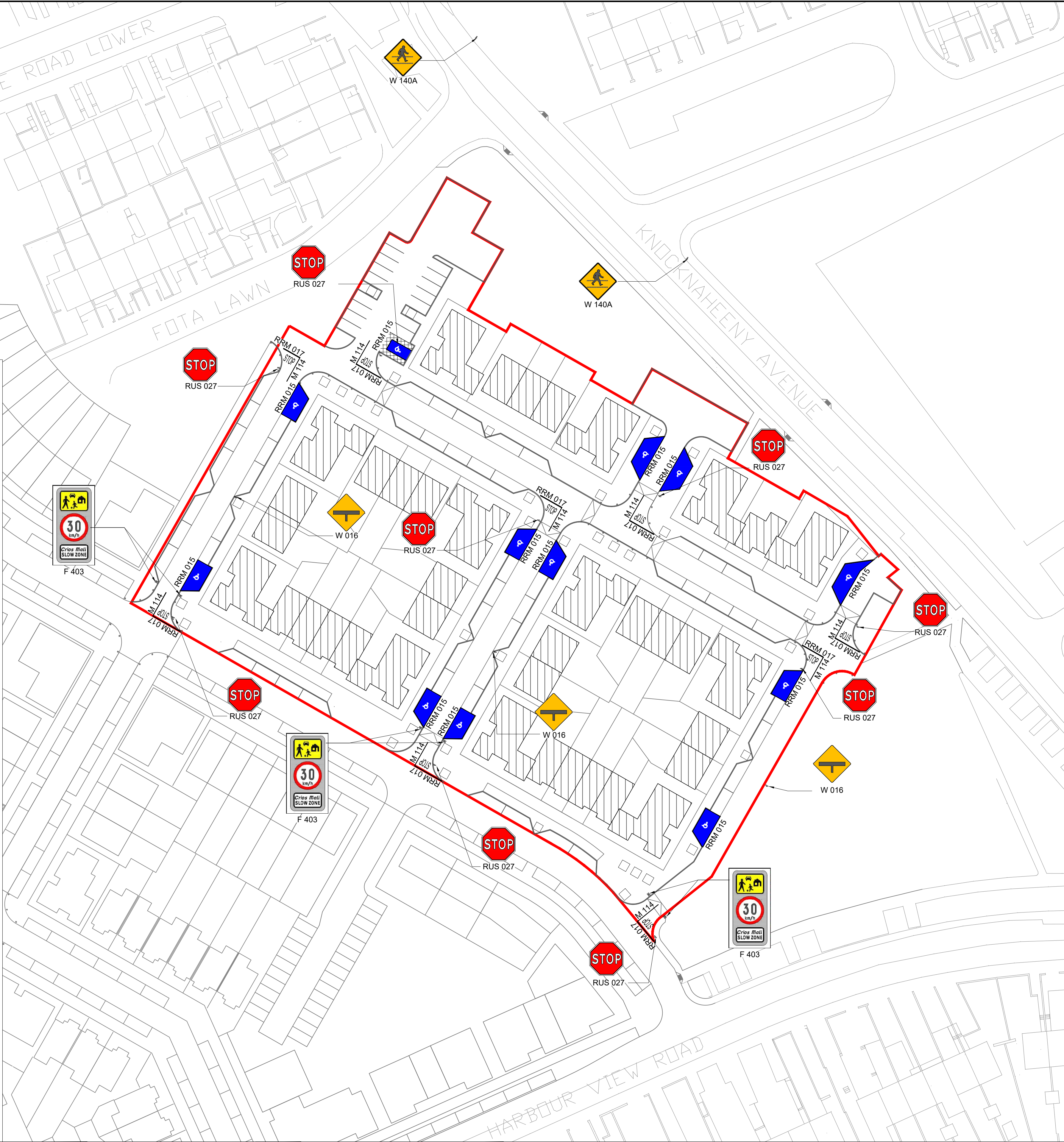

TYPICAL FOUNDATION DETAIL FOR SIGN POSTS IN PAVED AREAS:
N.T.S.
NOTES:
SIGNAGE AND SIGN HEIGHT TO BE INSTALLED IN ACCORDANCE WITH DEPARTMENT OF
TRANSPORT TRAFFIC SIGNS MANUAL.
ROADMARKINGS TO BE INSTALLED IN ACCORDANCE WITH DEPARTMENT OF TRANSPORT
CHAPTER 7 ROAD MARKINGS MANUAL



- ## GENERAL NOTES
1. ALL DIMENSIONS ARE IN MILLIMETRES UNLESS NOTED OTHERWISE
 2. ONLY WRITTEN DIMENSIONS SHALL BE USED. NO DIMENSIONS SHALL BE SCALED FROM THE DRAWINGS
 3. ALL LEVELS ARE IN METRES AND ARE TO MALIN HEAD DATUM
 4. ALL COORDINATES ARE IN METRES AND ARE TO IRISH TRANSVERSE MERCATOR
 5. DRAWINGS ARE TO BE READ IN CONJUNCTION WITH THE SPECIFICATION.

LEGEND:

	PHASE 3B BOUNDARY
	PROPOSED BUILDING
	PROPOSED BOLLARD

P04	ISSUED FOR PART 8 PLANNING	GM	14.04.22	MB	MOS
P03	ISSUED FOR PRE-PART 8	GM	23.02.22	MK	MOS
P02	REVISED FOR STAGE 2A	GM	13.08.21	MK	MOS
P01	ISSUED FOR STAGE 2A	GM	16.07.21	MK	MOS
Rev	Description	By	Date	Chk'd	Auth

ATKINS

Member of the SNC-Lavalin Group

Atkins House, 150 Airside Business Park, Swords, Co. Dublin
Tel (+353) 01 610 8000
Fax (+353) 01 810 8001

Unit 2B, 2200 Cork Airport Business Park, Cork
Tel (+353) 021 429 0300
Fax (+353) 021 429 0360

2nd Floor Technology House
Parkmore Technology Park, Galway
Tel (+353) 091 786 050
Fax (+353) 091 779 830

Client	Cork City Council		Title PROPOSED ROAD SIGNS AND TRAFFIC MARKINGS			
Project	CorkNW Regeneration Quarter Phase 3B		Original/Scale 1:500@A1 1:1000@A3	Design/Drawn GM	Checked MK	Authorised MOS
			Date	10.05.21	Date	10.05.21
			Status	Drawing Number		Rev
			P	CNW P3B-ATK-P3B-Z0-DR-C-951200		P04

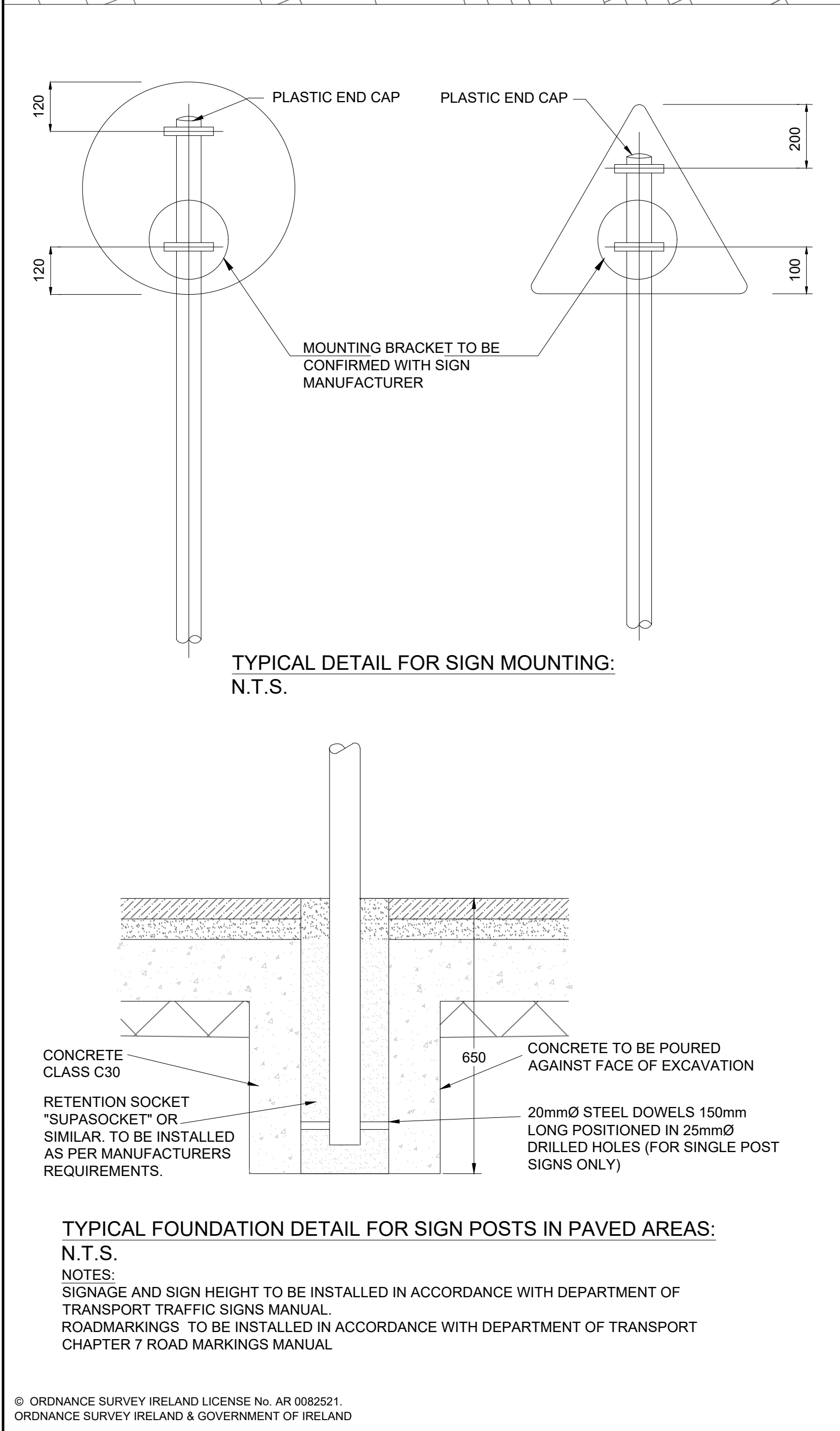

OS REFERENCE:
6382-02 6382-03

© ORDNANCE SURVEY IRELAND LICENSE No. AR 0082521.
ORDNANCE SURVEY IRELAND & GOVERNMENT OF IRELAND

Rev	Description	By	Date	Chk'd	Auth
P04	ISSUED FOR PART 8 PLANNING	GM	14.04.22	MB	MOS
P03	ISSUED FOR PRE-PART 8	GM	23.02.22	MK	MOS
P02	REVISED FOR STAGE 2A	GM	13.08.21	MK	MOS
P01	ISSUED FOR STAGE 2A	GM	16.07.21	MK	MOS

Atkins House, 150 Airside Business Park, Swords, Co. Dublin
Tel (+353) 01 810 8000
Fax (+353) 01 810 8001

Unit 2B, 2200 Cork Airport Business Park, Cork
Tel (+353) 021 429 0300
Fax (+353) 021 429 0360

2nd Floor Technology House Parkmore Technology Park, Galway
Tel (+353) 091 786 050
Fax (+353) 091 779 830

ATKINS
Member of the SNC-Lavalin Group

Client	Cork City Council
Project	CorkNW Regeneration Quarter Phase 3B

Title					
PROPOSED ROAD SIGNS AND TRAFFIC MARKINGS					
Original Scale		Design/Drawn		Checked	Authorised
1:500@A1		GM		MK	MOS
1:1000@A3		Date	Date	Date	Date
		10.05.21		10.05.21	10.05.21
Status	Drawing Number				Rev
P	CNW P3B-ATK-P3B-Z0-DR-C-951200				P04

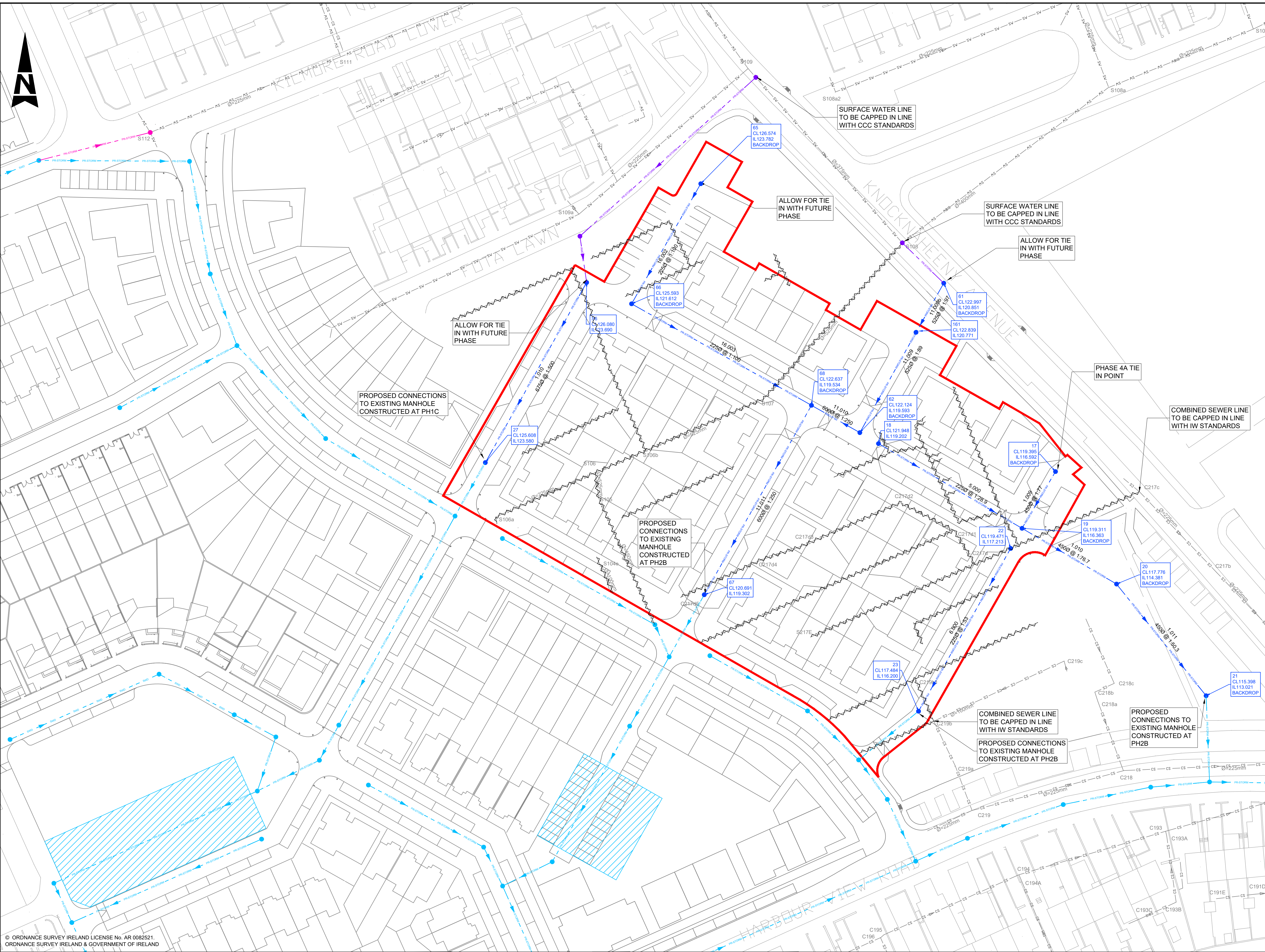

- GENERAL NOTES**
1. ALL DIMENSIONS ARE IN MILLIMETRES UNLESS NOTED OTHERWISE
 2. ONLY WRITTEN DIMENSIONS SHALL BE USED. NO DIMENSIONS SHALL BE SCALED FROM THE DRAWINGS
 3. ALL LEVELS ARE IN METRES AND ARE TO MALIN HEAD DATUM
 4. ALL COORDINATES ARE IN METRES AND ARE TO IRISH TRANSVERSE MERCATOR
 5. DRAWINGS ARE TO BE READ IN CONJUNCTION WITH THE SPECIFICATION.

- LEGEND:**
- PHASE 3B BOUNDARY
 - PROPOSED STORM SEWER PIPE FOR PHASE 3B
 - PROPOSED STORM SEWER MANHOLE FOR PHASE 3B
 - PROPOSED PIPE DETAILS SHOWING PIPE NUMBER, DIAMETER AND SLOPE FOR PHASE 3B
 - PROPOSED MANHOLE DETAILS SHOWING MANHOLE NUMBER, COVER LEVEL AND INVERT LEVEL FOR PHASE 3B
 - STORM SEWER PIPE SCHEMATIC LAYOUT AS PER MASTERPLAN PHASE DEVELOPMENTS FOR PHASES 1C, 2A, 2B AND 2C. REFER TO SPECIFIC PHASING PROJECT FOR DETAILS.
 - STORM SEWER MANHOLE AS PER MASTERPLAN PHASE DEVELOPMENTS FOR PHASES 1C, 2A, 2B AND 2C. REFER TO SPECIFIC PHASING PROJECT FOR DETAILS.
 - DIVERSION PIPE TO CONSTRUCTED AS PART OF PHASE 3B AND TO BE REMOVED AT SOME STAGE DURING FUTURE PHASES CONSTRUCTION
 - DIVERSION MANHOLE TO CONSTRUCTED AS PART OF PHASE 3B AND TO BE REMOVED AT SOME STAGE DURING FUTURE PHASES CONSTRUCTION
 - PIPE DETAILS SHOWING PIPE NUMBER, DIAMETER AND SLOPE FOR DIVERSION STORM SEWER NETWORK
 - MANHOLE DETAILS SHOWING MANHOLE NUMBER, COVER LEVEL AND INVERT LEVEL FOR DIVERSION STORM SEWER MANHOLE
 - TEMPORARY TIE IN INSTALLED AS PART OF PHASE 2C. PERMANENT TIE IN TO BE COMPLETED DURING PHASE 1C CONSTRUCTION
 - EXISTING STORM SEWER PIPE
 - EXISTING STORM SEWER PIPE TO BE REMOVED
 - EXISTING COMBINED SEWER PIPE
 - EXISTING COMBINED SEWER PIPE TO BE REMOVED

SPECIAL NOTES:

ALL DRAINAGE WORKS TO BE CONSTRUCTED IN ACCORDANCE WITH IRISH WATER STANDARD DETAILS FOR WASTEWATER NETWORKS DRAWINGS STD-WW-01 TO STD-WW-34 AND IN ACCORDANCE WITH CCC DRAINAGE DEPARTMENT REQUIREMENTS.

ALL DRAINAGE WORKS SHALL COMPLY WITH CORK CITY COUNCIL'S MINIMUM ENGINEERING REQUIREMENTS FOR NEW DEVELOPMENTS.

EXTENT OF EXISTING UTILITY SERVICES ON THE PHASE 3B SITE TO BE REVIEWED DURING DETAILED DESIGN.

© ORDNANCE SURVEY IRELAND LICENSE No. AR 0082521
ORDNANCE SURVEY IRELAND & GOVERNMENT OF IRELAND

OS REFERENCE:
6382-02 6382-03

Rev	Description	By	Date	Chk'd	Auth
P04	ISSUED FOR PART 8 PLANNING	GM	14.04.22	MB	MOS
P03	ISSUED FOR PRE-PART 8	GM	23.02.22	MK	MOS
P02	REVISED FOR STAGE 2A	GM	13.08.21	MK	MOS
P01	ISSUED FOR STAGE 2A	GM	16.07.21	MK	MOS

ATKINS
Member of the SNC-Lavalin Group

Atkins House, 150 Airside Business Park, Swords, Co. Dublin
Tel (+353) 01 810 8000
Fax (+353) 01 810 8001

Unit 2B, 2200 Cork Airport Business Park, Cork
Tel (+353) 021 429 0300
Fax (+353) 021 429 0360

2nd Floor Technology House Parkmore Technology Park, Galway
Tel (+353) 091 786 0550
Fax (+353) 091 779 830

Client
Cork City Council

Project
CorkNW Regeneration Quarter
Phase 3B

Purpose		PART 8 PLANNING	
Title		PROPOSED SURFACE WATER LAYOUT	
Original Scale	Design/Drawn	Checked	Authorised
1:500@A1 1:1000@A3	GM	MK	MOS
Date	Date	Date	Date
10.05.21	10.05.21	10.05.21	10.05.21
Status	Drawing Number	Rev	
P	CNW P3B-ATK-P3B-Z0-DR-C-960500	P04	

A1

DO NOT SCALE

File: CNW P3B-ATK-P3B-Z0-DR-C-962700.dwg
Date: Apr 18, 2022 - 7:29pm
Plotted by: MBrn

© ORDNANCE SURVEY IRELAND LICENSE No. AR 0082521
ORDNANCE SURVEY IRELAND & GOVERNMENT OF IRELAND

OS REFERENCE:
6382-02 6382-03

P04	ISSUED FOR PART 8 PLANNING	GM	14.04.22	MB	MOS
P03	ISSUED FOR PRE-PART 8	GM	23.02.22	MK	MOS
P02	REVISED FOR STAGE 2A	GM	13.08.21	MK	MOS
P01	ISSUED FOR STAGE 2A	GM	16.07.21	MK	MOS
Rev	Description	By	Date	Chk'd	Auth

Atkins House, 150 Airside Business Park, Swords, Co. Dublin
Tel (+353) 01 810 8000
Fax (+353) 01 810 8001

Unit 2B, 2200 Cork Airport Business Park, Cork
Tel (+353) 021 429 0300
Fax (+353) 021 429 0360

2nd Floor Technology House Parkmore Technology Park, Galway
Tel (+353) 091 786 050
Fax (+353) 091 779 830

ATKINS

Member of the SNC-Lavalin Group

Client
Cork City Council

Project
CorkNW Regeneration Quarter
Phase 3B

Purpose
PART 8 PLANNING

Title
PROPOSED WATERMAIN LAYOUT

Original Scale 1:500@A1 1:1000@A3	Design/Drawn GM Date 11.05.21	Checked MK Date 11.05.21	Authorised PC Date 11.05.21
Status P	Drawing Number CNW P3B-ATK-P3B-Z0-DR-C-962700	Rev P04	

GENERAL NOTES

- ALL DIMENSIONS ARE IN MILLIMETRES UNLESS NOTED OTHERWISE
- ONLY WRITTEN DIMENSIONS SHALL BE USED. NO DIMENSIONS SHALL BE SCALED FROM THE DRAWINGS
- ALL LEVELS ARE IN METRES AND ARE TO MALIN HEAD DATUM
- ALL COORDINATES ARE IN METRES AND ARE TO IRISH TRANSVERSE MERCATOR
- DRAWINGS ARE TO BE READ IN CONJUNCTION WITH THE SPECIFICATION.

LEGEND:

- PHASE 3B BOUNDARY
- PROPOSED Ø150mm DI WATERMAIN - WITHIN PHASE 3B PROJECT
- PROPOSED Ø100mm DI WATERMAIN - WITHIN PHASE 3B PROJECT
- PROPOSED Ø63mm DI WATERMAIN - WITHIN PHASE 3B PROJECT
- PROPOSED Ø100 DI DIVERSION WATERMAIN - WITHIN PHASE 3B PROJECT
- PROPOSED SLUICE VALVE - WITHIN PHASE 3B PROJECT
- PROPOSED HYDRANT - WITHIN PHASE 3B PROJECT
- Ø150mm DI WATERMAIN - OUTSIDE PHASE 3B PROJECT
- Ø100mm DI WATERMAIN - OUTSIDE PHASE 3B PROJECT
- SLUICE VALVE - OUTSIDE PHASE 3B PROJECT
- EXISTING WATERMAIN PIPE
- EXISTING WATERMAIN PIPE TO BE REMOVED

SPECIAL NOTES:

ALL WATERMAINS WORKS TO BE CONSTRUCTED IN ACCORDANCE WITH IRISH WATER STANDARD DETAILS FOR WATER NETWORKS DRAWINGS STD-W-01 TO STD-W-37. ALL WATERMAINS WORKS SHALL COMPLY WITH CORK CITY COUNCIL'S MINIMUM ENGINEERING REQUIREMENTS FOR NEW DEVELOPMENTS. SUCH REQUIREMENTS INCLUDE (BUT ARE NOT EXCLUSIVE TO); ALL VALVE TO BE ANTICLOCKWISE CLOSING, ALL FITTINGS TO BE PUSH FIT, SLUICE VALVES SHALL BE PLACED ON ALL BRANCHES INCLUDING HYDRANTS. ALL ROAD AND FOOTWAY WATER FITTING COVERS SHALL BE MARKED TO INDICATE WHAT IS UNDERNEATH. MARKER PLATES SHALL BE INSTALLED FOR ALL EXISTING AND NEW WATER MAIN FITTINGS ON OR ADJOINING THE SITE TO THE SATISFACTION OF CCC WATER DEPARTMENT.

EXTENT OF EXISTING UTILITY SERVICES ON THE PHASE 3B SITE TO BE REVIEWED DURING DETAILED DESIGN.

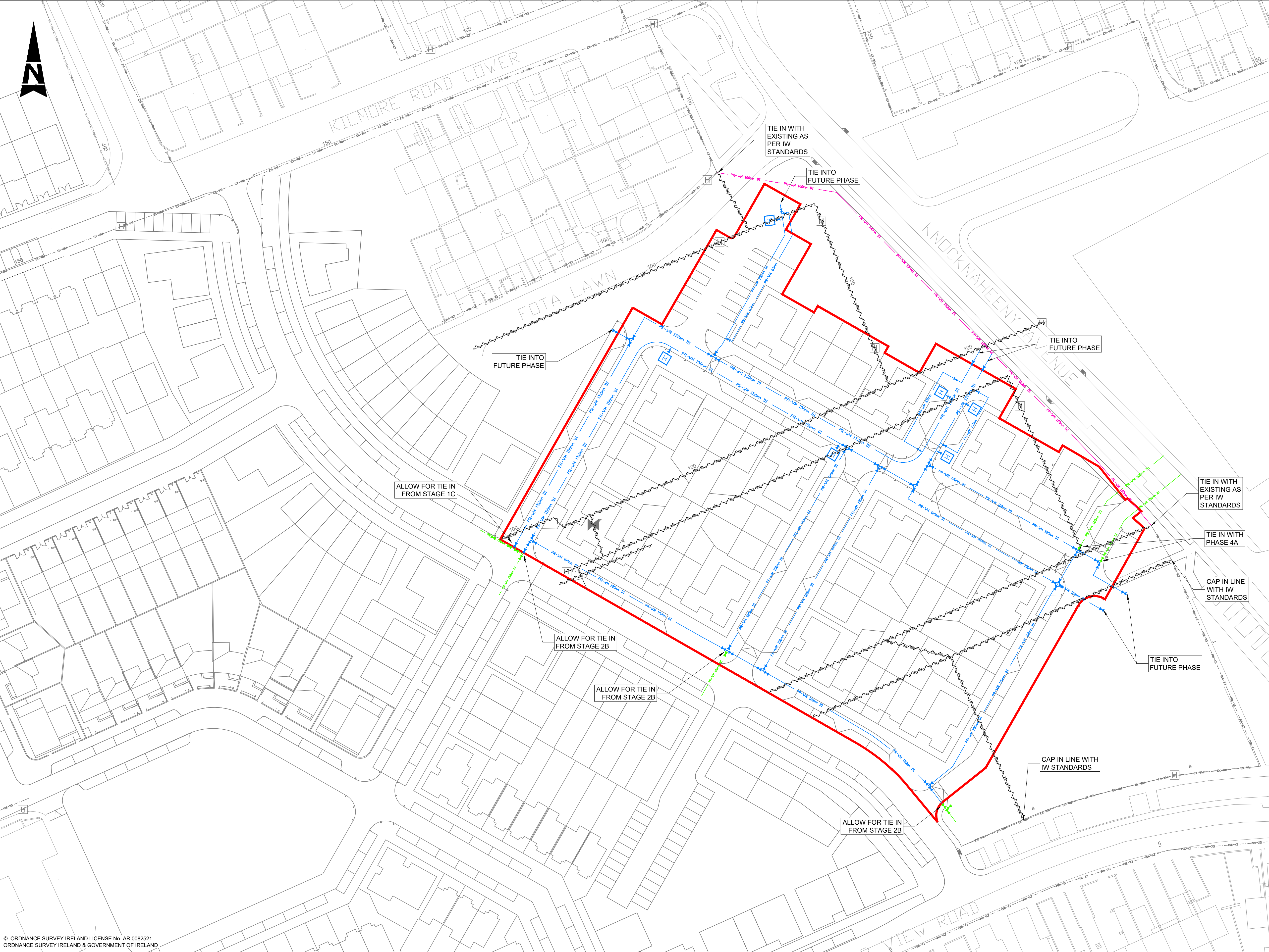

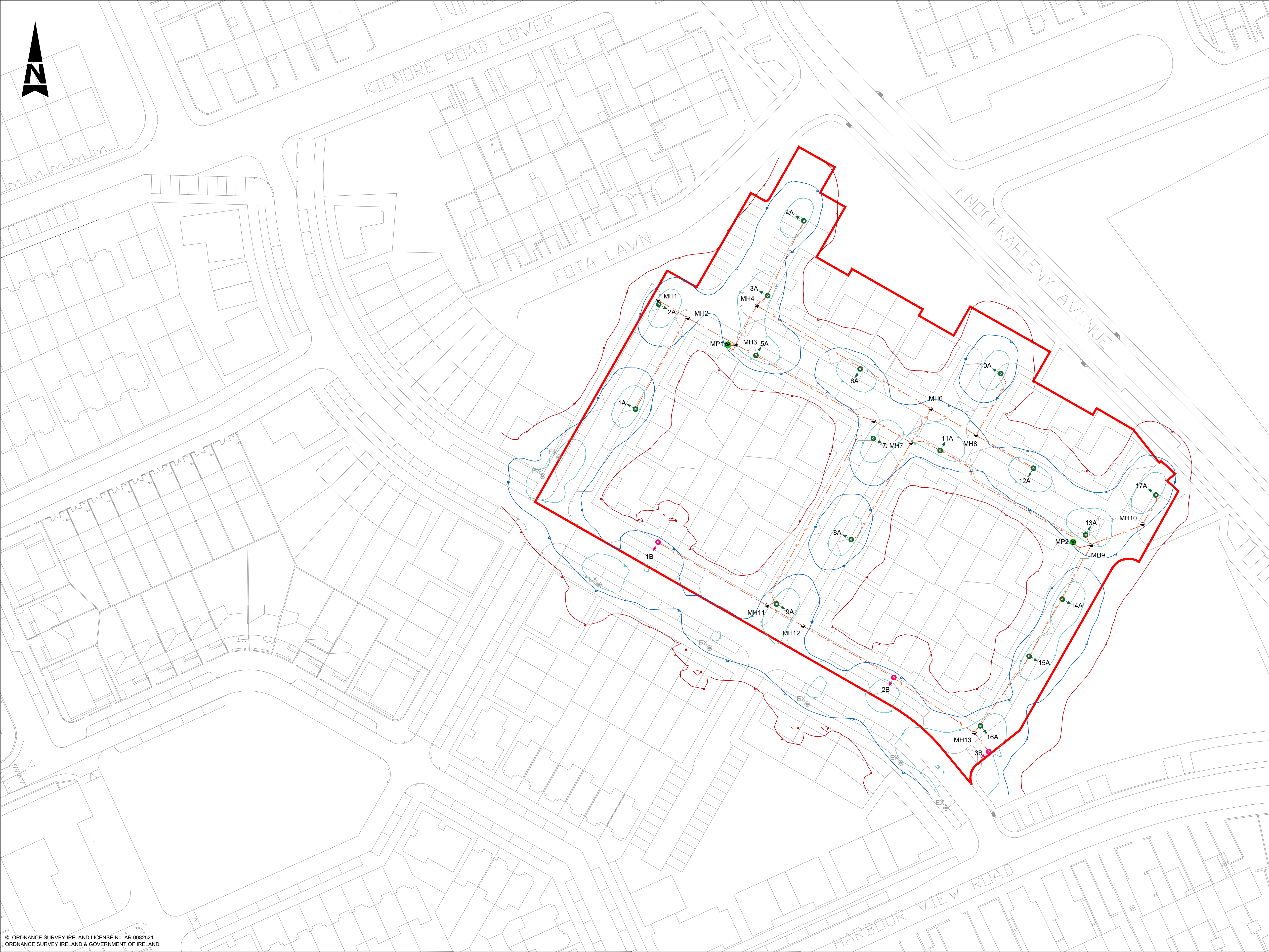

© ORDNANCE SURVEY IRELAND LICENSE No. AR 0082521.
ORDNANCE SURVEY IRELAND & GOVERNMENT OF IRELAND

OS REFERENCE:
6382-02 6382-03

Rev	Description	By	Date	Chk'd	Auth
P03	ISSUED FOR PART 8 PLANNING	GM	14.04.22	MB	MOS
P02	ISSUED FOR PRE_PART 8	GM	28.02.2022	AK	MOS
P01	ISSUED FOR STAGE 2A	GM	21.07.21	AK	MOS

ATKINS
Member of the SNC-Lavalin Group

Atkins House, 150 Airside Business Park, Swords, Co. Dublin
Tel (+353) 01 910 8000
Fax (+353) 01 810 8001

Unit 2B, 2200 Cork Airport Business Park, Cork
Tel (+353) 021 429 0300
Fax (+353) 021 429 0360

2nd Floor Technology House Parkmore Technology Park, Galway
Tel (+353) 091 786 050
Fax (+353) 091 779 830

Client	Cork City Council
Project	CorkNW Regeneration Quarter Phase 3B

- GENERAL NOTES**
- ALL DIMENSIONS ARE IN MILLIMETRES UNLESS NOTED OTHERWISE
 - ONLY WRITTEN DIMENSIONS SHALL BE USED. NO DIMENSIONS SHALL BE SCALED FROM THE DRAWINGS
 - ALL LEVELS ARE IN METRES AND ARE TO MALIN HEAD DATUM
 - ALL COORDINATES ARE IN METRES AND ARE TO IRISH TRANSVERSE MERCATOR
 - DRAWINGS ARE TO BE READ IN CONJUNCTION WITH THE SPECIFICATION.

- LEGEND:**
- PHASE 3B BOUNDARY
 - PUBLIC LIGHTING COLUMN (PROPOSED) - LUMINAIRE TYPE A
 - PUBLIC LIGHTING COLUMN (PROPOSED) - LUMINAIRE TYPE B
 - EXISTING LUMINAIRE FOR ADJACENT SCHEME
 - 10.0 LUX LEVELS
 - 5.0 LUX LEVELS
 - 1.0 LUX LEVELS
 - MH XX PUBLIC LIGHTING CHAMBER (PROPOSED)
 - XX PUBLIC LIGHTING MINI PILLAR - UNMETERED (LOCATED AT LEAST 2m FROM ESB PILLAR)
 - PUBLIC LIGHTING DUCT (PROPOSED)
2X6sq NYCY CABLE LAID IN DUCTING TO ETCl ET101.
SINGLE WALL DUCTING, COLOUR RED TO BE USED MANUFACTURED FROM HIGH DENSITY POLYETHYLENE (H.D.P.E.), 107mm EXTERNAL DIAMETER, HAVING A WALL THICKNESS OF 5mm. THIS DUCTING TO HAVE THE WORDS "STREET LIGHTING" STAMPED ON, LETTER SIZE 9mm AT 1m INTERVALS. THE LETTERING TO FACE UPPERMOST IN THE TRENCH. ALL WORKS TO LOCAL AUTHORITY SPECIFICATION. THIS IS A CIRCUIT LAYOUT AND NOT INDICATIVE OF WHERE DUCTS ARE TO BE LAID.

- LUMINAIRE SPECIFICATIONS**
- LUMINAIRE TYPE A DETAILS**
- | | |
|---------------------|---|
| TYPE: | P852-24-S1-NW-W7-0350-26W |
| OPTIC: | NW |
| LAMP: | 740SS |
| COLOUR TEMPERATURE: | 3000K |
| LAMP FLUX: | 3.55 |
| MAINTENANCE FACTOR: | 0.89 |
| NO IN PROJECT: | 17 |
| COLUMN HEIGHT: | 6.0m; ANTI-VANDAL (DOOR AT TOP OF COLUMN) |
| COLUMNS QUANTITIES: | AS INDICATED ON THE DRAWING |
| INCLINATION: | 0 DEGREES |
- LUMINAIRE TYPE B DETAILS**
- | | |
|---------------------|---|
| TYPE: | AXIA 2.1 5166 - 16 NVSL219CT |
| OPTIC: | NW |
| LAMP: | NVSL219CT |
| COLOUR TEMPERATURE: | 3000K |
| LAMP FLUX: | 3.34 |
| MAINTENANCE FACTOR: | 0.89 |
| NO IN PROJECT: | 3 |
| COLUMN HEIGHT: | 8.0m; ANTI-VANDAL (DOOR AT TOP OF COLUMN) |
| COLUMNS QUANTITIES: | AS INDICATED ON THE DRAWING |
| INCLINATION: | 0 DEGREES |

- SPECIAL NOTES:**
- ALL LED LANTERNS MUST HAVE CONSTANT LIGHT OUTPUT (CLO).
AUTOMATICALLY DIMMED TO 75% EACH NIGHT FROM 12 MIDNIGHT TO 6am.
ALL LANTERNS TO HAVE 7PIN NEMA SOCKETS FITTED.
- ELECTRONIC PHOTOCELLS SWITCHED AT 35/18LUX.
ALL COLUMNS, LUMINAIRES, CABLES AND PILLARS, SHALL COMPLY WITH LOCAL AUTHORITY GENERAL SPECIFICATION FOR PUBLIC LIGHTING.
- NO TREES TO BE LOCATED WITHIN FALLING DISTANCE OF P/L COLUMNS.
MINIMUM SET-BACK OF COLUMNS IS 800mm FROM FACE OF KERB.

Purpose	PART 8 PLANNING
Title	PROPOSED PUBLIC LIGHTING LAYOUT
Original Scale	1:500@A1 1:1000@A3
Design/Drawn	GM
Checked	AK
Authorised	MOS
Date	11.05.21
Date	11.05.21
Date	11.05.21
Status	P
Drawing Number	CNW P3B-ATK-P3B-Z0-DR-E-961300
Rev	P03

ATKINS

Day	19									
Month	04									
Year	22									

[illegible][illegible][illegible]